



# Pipe Systems with Quick Couplings

## Product Catalogue

# Table of contents

44 pages with everything you need for cost-effective pipe systems .....	5
Surface coatings for all conditions and needs.....	6

## **Alvenius® CG/RG 60–323 mm (2"–12") .....8**

Pipe CG (cut groove) .....	9
Pipe RG (roll groove).....	11
Coupling Flexible, model St 75 .....	11
Coupling Flexible, model St 77 .....	12
Coupling Rigid, model St 07 .....	12
Rubber gasket.....	13
Tee, CG (cut groove).....	13
Elbow, CG (cut groove).....	14
Reducer/Taper, CG (cut groove) .....	15
Adapter with thread CG (cut groove).....	16
Adapter CG – K10 .....	16
Hydrant outlet CG (cut groove) .....	16
Flanged adapter CG (cut groove).....	17
End cap.....	18
Welding ring CG .....	18
Valves .....	19
Plain end pipe .....	20
Accessories, assembly grease .....	21
Accessories, Denso Tape .....	21
Accessories, repair kit, CorroFlo®.....	21
Accessories, repair kit, tools.....	21

## **Alvenius® AGS 355–610 mm (14"–24") .....22**

Pipe AGS.....	23
Coupling Flexible, model AGS 77 .....	23

Coupling Rigid, model AGS 07 .....	24
Rubber gasket.....	24
Tee, AGS .....	24
Elbow, AGS .....	25
Reducer/Taper, AGS .....	26
Flanged adapter AGS .....	26
End cap AGS .....	27
Welding ring AGS .....	27
Plain end pipe .....	27

## **Alvenius® K10 48–318 mm (1½"–12") .....28**

Pipe K10.....	29
Coupling K10.....	30
Coupling K70 .....	31
Rubber gasket.....	31
Tee K10 .....	32
Branch 45° K10 .....	32
Tee with threaded outlet K10 .....	33
Elbow K10 .....	33
Reducer/Taper K10 .....	34
Adapter K10 with thread .....	35
Adapter K10 – CG .....	35
Flanged adapter K10 .....	36
Hose connection K10 .....	36
Butterfly valve K10 .....	37
Slide valve K10 .....	37
End cap K10.....	38
Welding ring .....	38

## **Type designation .....40**



AB Alvenius Industrier  
Box 550  
SE-631 07 Eskilstuna  
SWEDEN

Phone: +46 16 16 65 00  
Fax: +46 16 12 26 34  
E-mail: [info@alvenius.se](mailto:info@alvenius.se)  
[www.alvenius.com](http://www.alvenius.com)







# 44 pages with everything you need for cost-effective pipe systems

**Alvenius FlowMax® is a range of steel pipes, quick couplings and fittings including everything you need to design the market's most cost-effective pipe systems.**

Maximum reliability, top-grade safety, resistance to corrosion and aggressive media, long service life and superb life cycle costs (LCC) are key benefits built into all Alvenius FlowMax® systems.

Alvenius offers several systems, depending on the application, dimension and pressure rating requirements.

The Alvenius K10 system is widely used within Mining and Tunnelling for pressures up to 40 bar and in sizes ranging from 48 mm (1½") to 318 mm (12"). Pipes and fittings in the K10 system each have a welded "shoulder".

The Alvenius CG/Victaulic system is often used for permanent installations with sizes up to 323 mm (12"). Standard systems are available for pressures up to 80 bar, while systems for higher pressures can be made to order. Normally, thick-walled rings with a machined groove are used, welded to the ends of the pipes. This is why the system is called cut groove (CG). For low pressures, we also offer a roll groove (RG) system, with a directly groove rolled at the ends of each pipe. The CG/RG system is often referred to as a Victaulic system.

For larger pipe sizes, 355 mm–610 mm (14"–24"), we offer the AGS system. The AGS system is similar to the CG/RG system, but with the difference that the pipes have a greater wall thickness and the groove is further in from the end of the pipe. The AGS system normally has a pressure rating of 25 bar.

## **Certifications and norms**

Alvenius is certified according to the quality standard ISO 9001, the environmental standard ISO 14001 and the welding quality standard ISO 3834-2.

FlowMax® pipes are designed and manufactured according to the pressure equipment directive PED 2014/68/EU and the SS-EN 13480 series. Tolerances according to SS-EN 10217-1.

## **More information**

This product catalogue covers the entire standard Alvenius range: pipes, couplings, valves, elbows, tees, adapters, threaded outlets and more.

Further information about the company and our products can be found at: [www.alvenius.com](http://www.alvenius.com)

You can download drawings in formats such as CAD here: [www.alvenius.solidcomponents.com](http://www.alvenius.solidcomponents.com)



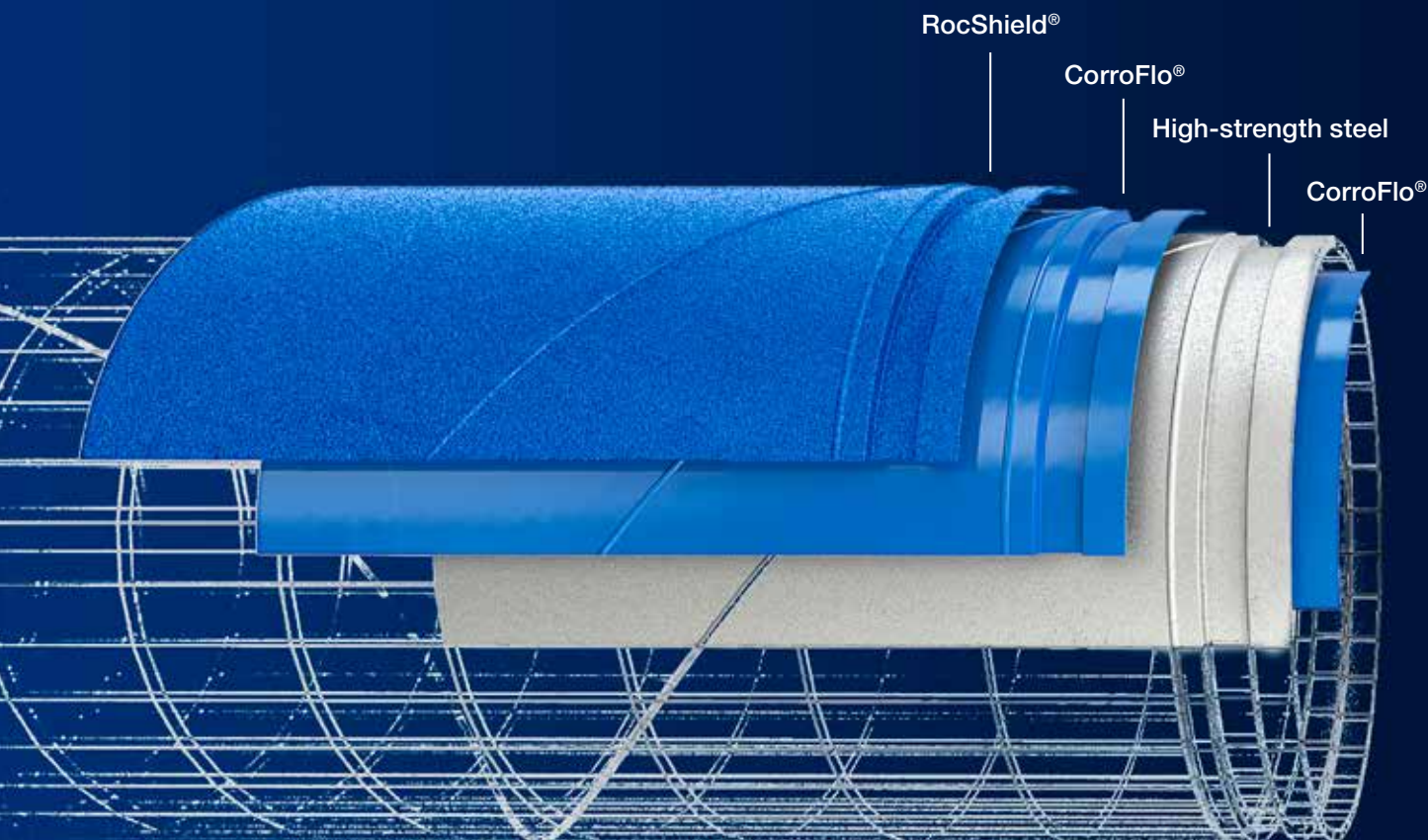

## Surface coatings for all conditions and needs

Demanding conditions, aggressive or abrasive media, strict hygiene requirements, the need for a cost-effective pipe system. No problem. Alvenius offers surface coatings to meet all needs and requirements and we guide you to the right solution.

**Typical applications for pipe systems from Alvenius include:**

- Mining industry and mineral processing
- Tunnelling applications
- Chemical industry
- Municipal water & wastewater
- Pulp and paper industry
- Food industry
- Offshore
- Construction and civil engineering
- District cooling
- Artificial snowmaking
- Fire protection
- Automotive industry

## HDG

HDG (Hot-Dip Galvanized) is an ideal surface coating for pipes that may need to be dismantled and reassembled as it provides a highly robust surface layer.

Such pipes are highly resistant to impact, wear and harsh weather conditions. What's more, the zinc layer "heals" if damaged.



## CorroFlo®

Alvenius FlowMax® pipes are coated both internally and externally with CorroFlo®. These pipes are ideal for environments and applications where, for example, acidic water and aggressive chemicals are a problem.

Tests show that CorroFlo® meets the requirements for the extremely demanding corrosion class SS-EN ISO 12944, which applies to marine environments (C5-M) and underground (Im3).

Independent tests show that pipes coated with CorroFlo® offer a service life of more than 50 years.



## RocShield®

For extra-durable wear and impact protection, the external surface of the pipes can be treated with RocShield® on top of the CorroFlo® coating.

RocShield® is a 500 µm LDPE layer that offers extreme resistance, making it suitable for pipes used in exposed environments.

The surface structure with its good gripping properties also offers easier and safer handling.



### Internal surface coating advantages

- Improved life cycle cost – extremely low flow resistance means lower energy consumption and lower overall costs
- Very good resistance to corrosion and chemicals
- Optimal hygiene properties – the smooth coating prevents the build-up of deposits inside the pipes
- Free from Bisphenol A

### External surface coating advantages

- Resistance to external impact on the pipes
- Superior service life – proven by independent tests in extreme environments
- Ideal in aggressive environments thanks to the high resistance to acidic and alkaline liquids
- Very good resistance to corrosion
- The surface coating has an elongation at failure of up to 800%
- Flexible and easy to repair if damaged



## Alvenius® CG/RG 60–323 mm (2"–12")

**CG/RG quick coupling system to ISO standard, normally for pressures up to 80 bar. Systems for higher pressures can be made to order. This system is also known as a roll groove or Victaulic system.**

Alvenius pipes are spiral welded using unique pressure vessel quality steel material. This means that the pipes can be made thin-walled yet strong. The combination of low weight and quick couplings makes a system that is extremely easy to manage and install.

The pipes are available with precision-welded rings at the ends for high pressures and with rolled groove for lower pressures.

### Properties

- Sizes 60–323 mm
- Rigid or flexible couplings
- Wide selection of rubber gaskets depending on the application and the type of media to be transported in the pipe
- Self-sealing gasket. Also works in vacuums under certain conditions.
- Deflection up to 2.5°
- Unaffected by vibrations
- Tolerates axial movement, such as due to heat expansion, thanks to axial play in the coupling

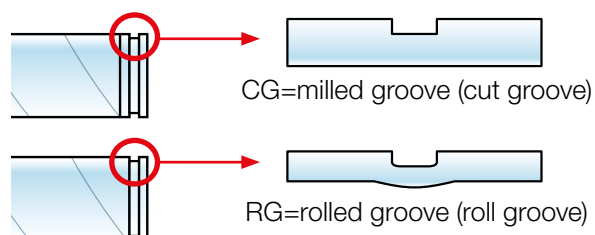



## Pipe CG (cut groove)

Our standard pipes are available with different pressure ratings depending on the application. Standard lengths are 6 m, but we also offer shorter pipes of various lengths for easy system adaptation.

For maximum reliability, all pipes are pressure tested with water at 1½ times the rated working pressure before leaving the factory.

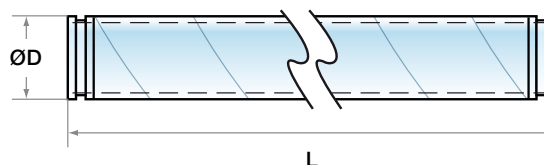

ØD [mm]	t [mm]	L [mm]	PN [bar] above ground	PN [bar] underground	Weight [kg]	Part no. Hot-dip galvanized	Part no. CorroFlo® •	Part no. RocShield® ••
60.3	1.8	200	80	80	0.7	101122801		
60.3	1.8	600	80	80	1.9	101123801		
60.3	1.8	1000	80	80	3.0	101125801		
60.3	1.8	3000	80	80	9.3	101127801		
60.3	1.8	6000	80	80	18.0	101130801		
76.1	2.0	200	63	63	1.0	2720-01		
76.1	2.0	600	63	63	2.4	100073801		
76.1	2.0	1000	63	63	4.1	100075801		
76.1	2.0	3000	63	63	13.1	100077801		
76.1	2.0	6000	63	63	23.7	1149-01		
88.9	4.3	70	80	80	0.5	3871-01	3871-0X	
88.9	4.3	100	80	80	0.8	3860-01	3860-0X	
88.9	2.1	200	80	80	1.4	122549801	12254980X	
88.9	2.1	600	80	80	3.4	122551801	12255180X	
88.9	2.1	1000	80	80	5.4	122091801	12209180X	
88.9	2.1	3000	80	80	16.2	122093801	12209380X	12209382X
88.9	2.1	6000	80	80	30.5	1151-01	1151-0X	1151-2X
114.3	4.3	70	80	80	0.7	3872-01	3872-0X	
114.3	4.3	100	80	80	1.0	3861-01	3861-0X	
114.3	2.7	200	80	80	2.1	122433801	12243380X	
114.3	2.7	600	80	80	5.7	122434801	12243480X	
114.3	2.7	1000	80	80	8.8	122435801	12243580X	
114.3	2.7	3000	80	80	25.0	122437801	12243780X	12243782X
114.3	2.0	6000	40	40	37.0	100422801	10042280X	10042282X
114.3	2.7	6000	80	80	47.3	1135-01	1135-0X	1135-2X
139.7	5.5	70	63	80	1.1	3873-01	3873-0X	
139.7	5.5	100	63	80	1.6	3862-01	3862-0X	
139.7	3.3	200	80	80	2.5	122818801	12281880X	
139.7	3.3	600	80	80	7.3	122829801	12282980X	
139.7	3.3	1000	80	80	11.7	122820801	12282080X	
139.7	3.3	3000	80	80	36.0	122821801	12282180X	12282182X
139.7	2.1	6000	40	40	46.3	1136-01	1136-0X	1136-2X
139.7	3.3	6000	80	80	69.9	122823801	12282380X	12282382X
168.3	5.2	70	63	80	1.2	3874-01	3874-0X	
168.3	5.2	100	63	80	1.9	3863-01	3863-0X	
168.3	2.8	200	63	80	3.6	122451801	12245180X	
168.3	2.8	600	63	80	8.1	122446801	12244680X	
168.3	2.8	1000	63	80	12.9	122762801	12276280X	

Cont. on next page ►

- X=5 Black CorroFlo®, X=6 White CorroFlo®, X=7 Red CorroFlo®, X=9 Blue CorroFlo®
- X=5 Black RocShield®, X=6 White RocShield®, X=7 Red RocShield®, X=9 Blue RocShield®

## Pipe CG (cut groove), cont.

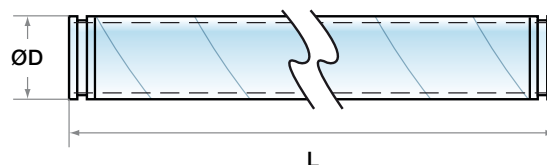

ØD [mm]	t [mm]	L [mm]	PN [bar] above ground	PN [bar] underground	Weight [kg]	Part no. Hot-dip galvanized	Part no. CorroFlo® •	Part no. RocShield® ••
168.3	2.8	3000	63	80	37.2	122763801	12276380X	12276382X
168.3	2.1	6000	40	40	56.6	1137-01	1137-0X	1137-2X
168.3	2.8	6000	63	80	72.5	1138-01	1138-0X	1138-2X
219.1	6.1	70	63	80	1.9	3933-01	3933-0X	
219.1	6.1	100	63	80	2.8	3865-01	3865-0X	
219.1	3.6	200	63	80	4.9	122401801	12240180X	
219.1	3.6	600	63	80	12.8	122920801	12292080X	
219.1	3.6	1000	63	80	21.0	122403801	12240380X	
219.1	3.6	3000	63	80	60.3	122404801	12240480X	12240482X
219.1	3.0	6000	25	40	102.0	100885801	10088580X	10088582X
219.1	3.6	6000	63	80	120.8	122407801	12240780X	12240782X
273.0	7.0	70	63	80	2.7	3934-01	3934-0X	
273.0	7.0	100	63	80	4.1	3866-01	3866-0X	
273.0	3.6	200	40	63	8.2	1607-01	1607-0X	
273.0	4.4	200	63	80	7.3	122339801	12233980X	
273.0	3.6	600	40	63	16.0	122340801	12234080X	
273.0	4.4	600	63	80	19.9	122343801	12234380X	
273.0	3.6	1000	40	63	25.5	122325801	12232580X	
273.0	4.4	1000	63	80	32.0	122345801	12234580X	
273.0	3.6	3000	40	63	73.4	122327801	12232780X	12232782X
273.0	4.4	3000	63	80	92.2	122346801	12234680X	12234682X
273.0	3.0	6000	25	35	129.2	1139-01	1139-0X	1139-2X
273.0	3.6	6000	40	63	152.5	1140-01	1140-0X	1140-2X
273.0	4.4	6000	63	80	183.3	1141-01	1141-0X	1141-2X
323.9	8.2	70	63	80	3.7	3935-01	3935-0X	
323.9	8.2	100	63	80	5.6	3932-01	3932-0X	
323.9	3.0	200	25	30	7.7	100758801	10075880X	
323.9	4.4	200	40	63	9.7	122857801	12285780X	
323.9	5.7	200	63	80	13.9	2731-01	2731-0X	
323.9	3.0	600	25	30	17.8	100767801	10076780X	
323.9	4.4	600	40	63	23.6	122862801	12286280X	
323.9	5.7	600	63	80	28.7	122960801	12296080X	
323.9	3.0	1000	25	30	31.7	100773801	10077380X	
323.9	4.4	1000	40	63	38.3	122861801	12286180X	
323.9	5.7	1000	63	80	50.6	2732-01	2732-0X	
323.9	3.0	3000	25	30	77.5	100765801	10076580X	10076582X
323.9	4.4	3000	40	63	109.2	122863801	12286380X	12286382X
323.9	5.7	3000	63	80	138.3	122316801	12231680X	12231682X
323.9	3.0	6000	25	30	156.1	1142-01	1142-0X	1142-2X
323.9	4.4	6000	40	63	220.6	1143-01	1143-0X	1143-2X
323.9	5.7	6000	63	80	279.9	1144-01	1144-0X	1144-2X

For larger sizes, see the section Alvenius AGS.

- X=5 Black CorroFlo®, X=6 White CorroFlo®, X=7 Red CorroFlo®, X=9 Blue CorroFlo®
- X=5 Black RocShield®, X=6 White RocShield®, X=7 Red RocShield®, X=9 Blue RocShield®

## Pipe RG (roll groove)

Alvenius FlowMax® pipes are spiral welded using unique pressure vessel quality steel material.

This means that the pipes can be made thin-walled yet strong while the spiral welding keeps the pipes straight.

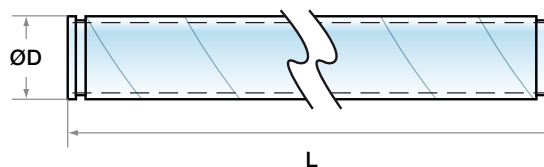

ØD [mm]	t [mm]	L [mm]	PN [bar] above ground	Weight [kg]	Part no. Hot-dip galvanized
76.1	2.0	6000	63	23.9	100080901
88.9	2.0	6000	40	27.9	100090901
114.3	2.0	6000	25	36.1	100422901
139.7	2.5	6000	40	54.5	100823901
168.3	2.5	6000	25	65.6	100444901
219.1	3.6	6000	63	120.0	122878901
273.0	3.6	6000	25	152.0	122771901
323.9	4.4	6000	25	219.9	122864901

For larger sizes, see the section Alvenius AGS.

## Coupling Flexible, model St 75

Incl. rubber gasket (EPDM).

Flexible coupling for pressures up to PN25. Flexible means that the coupling allows for some deflection and play, such as due to vibrations or temperature fluctuations. Contact Alvenius if you are uncertain as to which type of coupling to use.

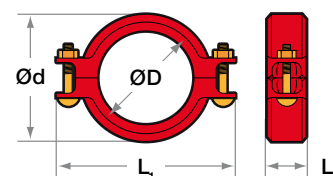

Product	ØD [mm]	Ød [mm]	L <sub>1</sub> [mm]	L <sub>2</sub> [mm]	Max. de- flexion °	PN [bar] above ground	PN [bar] under- ground	Weight [kg]	Part no. Painted	Part no. Hot-dip galvanized	Part no. CorroFlo® •
St 75	60.3	87	133	48	1.52	25	25	0.8	120930800	120930801	
St 75	76.1	102	150	48	1.20	25	25	1.0	120931800	120931801	
St 75	88.9	114	178	48	1.03	25	25	1.3	120932800	120932801	12093280X
St 75	114.3	147	204	54	2.40	25	25	1.9	120933800	120933801	12093380X
St 75	139.7	173	244	54	1.95	25	25	2.7	120937800	120937801	12093780X
St 75	168.3	203	281	58	1.63	25	25	3.2	120935800	120935801	12093580X
St 75	219.1	263	355	59	1.25	25	25	5.8	120936800	120936801	12093680X

For larger sizes, see the section Alvenius AGS.



## Coupling Flexible, model St 77

Incl. rubber gasket (EPDM).

Robust flexible coupling for pressures up to PN63 depending on size (PN80 for underground systems). Flexible means that the coupling allows for some deflection and play, such as due to vibrations or temperature fluctuations. Contact Alvenius if you are uncertain as to which type of coupling to use.

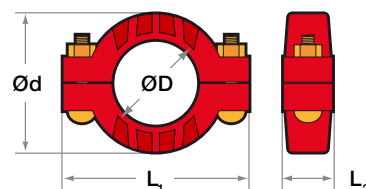

Product	ØD [mm]	Ød [mm]	L <sub>1</sub> [mm]	L <sub>2</sub> [mm]	Max. deflection °	PN [bar] above ground	PN [bar] under-ground	Weight [kg]	Part no. Painted	Part no. Hot-dip galvanized	Part no. CorroFlo® •
St 77	60.3	92	149	48	1.52	63	80	1.2	4013-10	4013-01	
St 77	76.1	111	168	48	1.20	63	80	1.3	120808800	120808801	
St 77	88.9	127	181	48	1.03	63	80	2.0	120809800	120809801	12080980X
St 77	114.3	156	226	54	2.40	63	80	3.0	120943800	120943801	12094380X
St 77	139.7	219	270	54	1.95	63	80	5.0	120813800	120813801	12081380X
St 77	168.3	219	302	54	1.63	63	80	5.4	120811800	120811801	12081180X
St 77	219.1	279	375	63	1.25	40	80	9.4	120804800	120804801	12080480X
St 77	273.0	346	435	67	1.00	40	80	13.9	120825800	120825801	12082580X
St 77	323.9	397	489	67	0.85	40	80	13.0	120826800	120826801	12082680X

For larger sizes, see the section Alvenius AGS.

## Coupling Rigid, model St 07

Incl. rubber gasket (EPDM).

Rigid coupling for pressures up to PN40 depending on size. Rigid means that the coupling is completely rigid and equivalent to a welded joint. Contact Alvenius if you are uncertain as to which type of coupling to use.

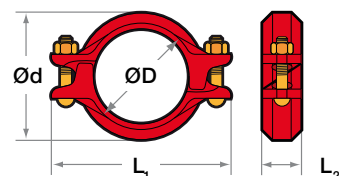

Product	ØD [mm]	Ød [mm]	L <sub>1</sub> [mm]	L <sub>2</sub> [mm]	Max. deflection °	PN [bar] above ground	PN [bar] under-ground	Weight [kg]	Part no. Painted	Part no. Hot-dip galvanized	Part no. CorroFlo® •
St 07	60.3	85	147	47	0.00	40	40	1.0	120910800	120910801	
St 07	76.1	107	168	47	0.00	40	40	1.6	120911800	120911801	
St 07	88.9	115	173	47	0.00	40	40	1.4	120912800	120912801	12091280X
St 07	114.3	148	209	53	0.00	40	40	2.5	120913800	120913801	12091380X
St 07	139.7	176	249	53	0.00	40	40	3.6	120914800	120914801	12091480X
St 07	168.3	210	275	53	0.00	40	40	3.7	120915800	120915801	12091580X
St 07	219.1	268	349	64	0.00	40	40	7.0	120949800	120949801	12094980X
St 07	273.0	327	431	65	0.00	25	25	11.0	120916800	120916801	12091680X
St 07	323.9	327	480	65	0.00	25	25	12.9	120917810	120917801	12091780X

For larger sizes, see the section Alvenius AGS.

## Rubber gasket

EPDM rubber gaskets are included as standard with all couplings. If you need other rubber gaskets or additional spare rubber gaskets, a wide selection of gaskets are available depending on the application and media.

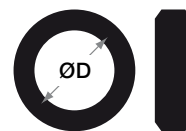

ØD [mm]	Weight [kg]	Part no.
60.3	0.1	120803801
76.1	0.1	120797801
88.9	0.1	120449801
114.3	0.1	120805801
139.7	0.1	120798801
168.3	0.1	120806801
219.1	0.3	120807801
273.0	0.7	120799801
323.9	0.8	120800801

For larger sizes, see the section Alvenius AGS.

## Tee, CG (cut groove)

The standard range includes a wide selection of straight tees, reducer tees and tees with threaded outlets.

Branch pipes, which are tees with a 45° branch, are available.

Tees are supplied with the same surface coating as the rest of the system.

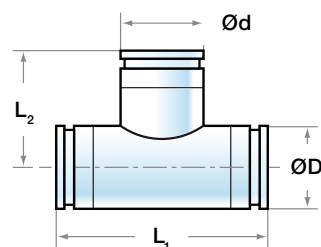

ØD [mm]	Ød [mm]	L <sub>1</sub> [mm]	L <sub>2</sub> [mm]	PN [bar] above ground	PN [bar] underground	Weight [kg]	Part no. Hot-dip galvanized	Part no. CorroFlo® •
60.3	60.3	166	83	63	80	1.4	122700801	
76.1	76.1	190	95	63	80	2.4	122701801	
88.9	88.9	216	108	63	80	3.2	122100801	12210080X
114.3	60.3	254	127	63	80	5.1	122737801	12273780X
114.3	76.1	254	127	63	80	5.2	122739801	12273980X
114.3	88.9	254	127	63	80	7.5	2581-01	2581-0X
114.3	114.3	254	127	63	80	6.0	122105801	12210580X
139.7	139.7	280	140	63	80	8.5	122109801	12210980X
168.3	60.3	330	165	63	80	9.8	122736801	12273680X
168.3	76.1	330	165	63	80	11.7	122720801	12272080X
168.3	88.9	330	165	63	80	12.0	122738801	12273880X
168.3	114.3	330	165	63	80	11.5	122116801	12211680X
168.3	168.3	330	165	63	80	11.7	122115801	12211580X
219.1	88.9	394	197	40	80	15.2	3636-01	3636-0X
219.1	114.3	394	197	40	80	19.3	2582-01	2582-0X
219.1	168.3	394	197	40	80	19.6	122731801	12273180X
219.1	219.1	394	197	40	80	21.6	122120801	12212080X
273.0	273.0	458	229	40	80	45.0	122735801	12273580X
323.9	273.0	508	254	40	80	38.0	122906801	12290680X
323.9	323.9	508	254	40	80	60.0	122905801	12290580X

For larger sizes, see the section Alvenius AGS.

## Elbow, CG (cut groove)

Elbows are used when the deflection offered by the coupling is insufficient.  
Elbows are supplied with the same surface coating as the rest of the system.

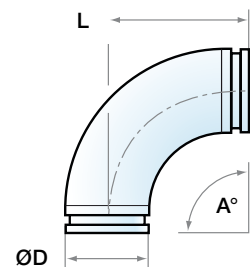

ØD [mm]	A°	L [mm]	PN [bar] above ground	PN [bar] underground	Weight [kg]	Part no. Hot-dip galvanized	Part no. CorroFlo® •
60.3	7.50	46.0	80	80	0.5	3771-01	
60.3	11.25	35.0	63	80	0.5	122466801	
60.3	22.50	48.0	63	80	0.7	122467801	
60.3	45.00	51.0	63	80	0.7	122468801	
60.3	90.00	83.0	63	80	0.9	122469801	
76.1	7.50	56.0	16	16	0.7	110487801	
76.1	11.25	38.0	40	80	0.8	1132-01	
76.1	22.50	51.0	40	80	1.0	1133-01	
76.1	45.00	57.0	63	80	1.0	122490801	
76.1	90.00	95.0	63	80	1.4	122492801	
88.9	7.50	47.5	80	80	0.6	122508801	12250880X
88.9	11.25	38.0	63	80	1.0	122507801	12250780X
88.9	22.50	57.0	63	80	1.4	122510801	12251080X
88.9	45.00	64.0	63	80	1.4	122511801	12251180X
88.9	90.00	108.0	63	80	2.0	122513801	12251380X
114.3	7.50	47.5	80	80	1.4	122543801	12254380X
114.3	11.25	45.0	63	80	1.6	122542801	12254280X
114.3	22.50	73.0	63	80	2.5	122545801	12254580X
114.3	45.00	76.0	63	80	2.5	122546801	12254680X
114.3	90.00	127.0	63	80	3.4	122548801	12254880X
139.7	7.50	52.5	80	80	4.2	122600801	12260080X
139.7	11.25	51.0	63	80	2.2	3792-01	3792-0X
139.7	22.50	51.0	63	80	3.5	3793-01	3793-0X
139.7	45.00	83.0	63	80	3.8	122603801	12260380X
139.7	90.00	140.0	63	80	5.3	122604801	12260480X
168.3	7.50	55.0	80	80	3.0	122376801	12237680X
168.3	11.25	51.0	63	80	3.2	122380801	12238080X
168.3	22.50	79.0	63	80	5.5	122378801	12237880X
168.3	45.00	89.0	63	80	6.2	122379801	12237980X
168.3	90.00	165.0	63	80	7,8	122381801	12238180X
219.1	7.50	65.0	80	80	6.9	122641801	12264180X
219.1	11.25	51.0	40	80	4.6	122645801	12264580X
219.1	22.50	98.0	40	80	10.0	122643801	12264380X
219.1	45.00	108.0	40	80	9.3	122644801	12264480X
219.1	90.00	197.0	40	80	13.6	122646801	12264680X
273.0	7.50	75.0	63	63	11.0	122669801	12266980X
273.0	11.25	54.0	40	80	5.4	2601-01	2601-0X
273.0	22.50	111.0	40	80	13.6	2910-01	2910-0X
273.0	45.00	121.0	40	80	22.4	1082-01	1082-0X
273.0	90.00	229.0	40	80	29.0	1078-01	1078-0X
323.9	7.50	80.0	63	63	17.0	122697801	12269780X

Cont. on next page ►



## Elbow, CG (cut groove), cont.

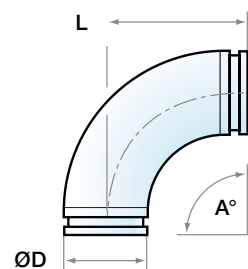

ØD [mm]	A°	L [mm]	PN [bar] above ground	PN [bar] underground	Weight [kg]	Part no. Hot-dip galvanized	Part no. CorroFlo® •
323.9	15.00	110.0	63	63	20.0	122698801	12269880X
323.9	30.00	172.0	63	63	30.3	122699801	12269980X
323.9	45.00	133.0	40	80	22.5	122703801	12270380X
323.9	90.00	254.0	40	80	36.7	122702801	12270280X

For larger sizes, see the section Alvenius AGS.

## Reducer/Taper, CG (cut groove)

Reducers are used to connect pipes of different diameters.

The standard range includes a wide selection of reducers for connecting different diameters and reducers with threaded outlets.

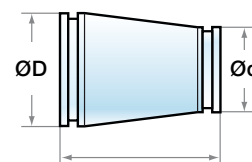

ØD [mm]	Ød [mm]	L [mm]	PN [bar] above ground	PN [bar] underground	Weight [kg]	Part no. Hot-dip galvanized	Part no. CorroFlo® •
76.1	60.3	64	63	80	0.8	1088-01	
88.9	60.3	64	63	80	0.8	122042801	
88.9	76.1	64	63	80	0.9	122043801	
114.3	60.3	229	63	80	1.1	122044801	
114.3	76.1	76	63	80	1.2	122047801	
114.3	88.9	76	63	80	1.5	122870801	12287080X
139.7	88.9	102	63	80	2.5	122897801	12289780X
139.7	114.3	89	63	80	1.9	122048801	12204880X
168.3	60.3	102	63	80	3.0	122858801	12285880X
168.3	88.9	102	63	80	2.9	122859801	12285980X
168.3	114.3	102	63	80	3.0	122876801	12287680X
168.3	139.7	102	63	80	2.9	122875801	12287580X
219.1	114.3	127	40	80	5.0	122890801	12289080X
219.1	139.7	127	40	80	5.0	122054801	12205480X
219.1	168.3	127	40	80	5.5	122877801	12287780X
273.0	114.3	152	40	80	8.9	111903801	11190380X
273.0	168.3	152	40	80	9.1	111881801	11188180X
273.0	219.1	152	40	80	12.0	122882801	12288280X
323.9	168.3	178	40	80	11.2	122209801	12220980X
323.9	219.1	178	40	80	23.8	122208801	12220880X
323.9	273.0	178	40	80	17.7	122207801	12220780X

For larger sizes, see the section Alvenius AGS.

## Adapter with thread CG (cut groove)

Adapter with thread used to connect pipes to, for example, threaded valves or a threaded pipe system.

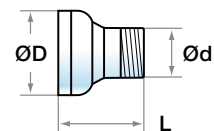

ØD [mm]	Ød [mm]	L [mm]	PN [bar] above ground	PN [bar] underground	Weight [kg]	Part no. Hot-dip galvanized
60.3	R1"	64	63	63	0.3	1248-01
60.3	R2"	140	40	40	0.7	110217801
88.9	R2"	64	40	40	0.7	1127-01
114.3	R2"	207	80	80	2.7	122238801
139.7	R2"	234	63	63	2.8	110228801
168.3	R2"	247	80	80	7.0	122240801
219.1	R2"	176	40	40	5.3	110241801

## Adapter CG – K10

Used to connect the K10 and CG systems.

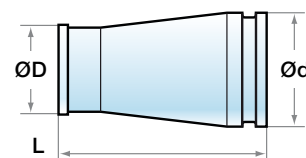

ØD [mm]	Ød [mm]	L [mm]	PN [bar] above ground	PN [bar] underground	Weight [kg]	Part no. Hot-dip galvanized	Part no. CorroFlo® •
60.3	60.3	88	40	40	0.5	111896801	
76.1	76.1	88	40	40	0.6	4439-01	
101.6	114.3	88	40	40	1.0	112046801	11204680X
152.4	139.7	88	40	40	1.5	111873801	
152.4	168.3	88	40	40	3.0	111874801	11187480X
203.2	219.1	93	40	40	3.6	111879801	

## Hydrant outlet CG (cut groove)

A hydrant outlet is an extended tee with a 2" externally threaded outlet (1½" outlets available on request). Supplied with the same surface coating as the rest of the system.

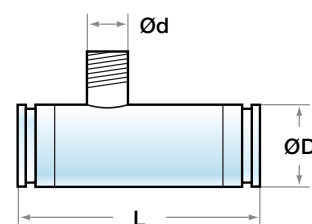

ØD [mm]	Ød [mm]	DN	L [mm]	PN [bar] above ground	PN [bar] underground	Weight [kg]	Part no. Hot-dip galvanized	Part no. CorroFlo® •
88.9	R2"	80	600	80	80	8.0	2930-01	2930-0X
114.3	R2"	100	600	80	80	10.3	2931-01	2931-0X
139.7	R2"	125	600	80	80	14.5	2932-01	2932-0X
168.3	R2"	150	600	80	80	19.5	2933-01	2933-0X
219.1	R2"	200	600	80	80	37.0	2934-01	2934-0X
273.0	R2"	250	600	80	80	39.2	2935-01	2935-0X
323.9	R2"	300	600	80	80	48.3	122497801	12249780X

## Flanged adapter CG (cut groove)

Alvenius offers flanged connectors to easily connect the system to, for example, other pipe systems and flanged valves.

We can supply all types of DIN and ANSI flanges with different pressure ratings.

The entire flanged connector is supplied with the same surface coating as the rest of the system.

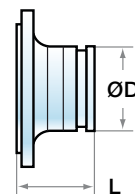

ØD [mm]	DN	DIN	L [mm]	PN [bar] above ground	PN [bar] underground	Weight [kg]	Part no. Hot-dip galvanized	Part no. CorroFlo® •
60.3	50	2633	90.0	16	16	3.0	111773801	
60.3	50	2635	93.0	40	40	2.3	111771801	
76.1	65	2633	87.0	16	16	3.4	3352-01	
76.1	65	2635	70.3	40	40	4.1	111774801	
88.9	80	2633	95.0	16	16	4.2	111775801	11177580X
88.9	80	2635	103.0	40	40	5.7	111777801	11177780X
88.9	80	2636	117.0	63	63	7.8	111776801	11177680X
114.3	100	2633	97.0	16	16	5.0	2301-01	2301-0X
114.3	100	2635	110.0	40	40	7.2	111782801	11178280X
114.3	100	2636	123.0	63	63	10.4	111783801	11178380X
139.7	125	2633	113.0	16	16	8.0	3088-01	3088-0X
139.7	125	2635	113.0	40	40	10.5	111787801	11178780X
139.7	125	2636	131.0	63	63	16.1	111788801	11178880X
168.3	150	2633	100.0	16	16	8.5	1596-01	1596-0X
168.3	150	2635	120.0	40	40	14.8	111765801	11176580X
168.3	150	2636	140.0	63	63	23.3	111766801	11176680X
219.1	200	2632	107.0	10	10	13.0	111792811	11179281X
219.1	200	2633	107.0	16	16	12.7	111791801	11179180X
219.1	200	2634	125.0	25	25	18.9	111792821	11179282X
219.1	200	2635	133.0	40	40	23.5	111792801	11179280X
219.1	200	2636	155.0	63	63	36.8	111793801	11179380X
273.0	250	2632	115.0	10	10	17.8	3089-01	3089-0X
273.0	250	2633	120.0	16	16	18.1	111797801	11179780X
273.0	250	2634	138.0	25	25	27.0	111796801	11179680X
273.0	250	2635	170.0	40	40	38.1	3091-01	3091-0X
273.0	250	2636	175.0	63	63	53.0	111798801	11179880X
323.9	300	2632	118.0	10	10	21.2	1608-01	1608-0X
323.9	300	2633	137.0	16	16	30.1	3090-01	3090-0X
323.9	300	2634	137.0	25	25	38.1	3074-01	3074-0X
323.9	300	2635	165.0	40	40	52.5	111804801	11180480X
323.9	300	2636	190.0	63	63	70.3	111805801	11180580X

For larger sizes, see the section Alvenius AGS.



## End cap

End caps are available in all sizes.

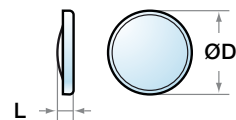

ØD [mm]	L [mm]	PN [bar] above ground	PN [bar] underground	Weight [kg]	Part no. Hot-dip galvanized	Part no. CorroFlo® •
60.3	25	63	80	0.3	122351801	
76.1	25	63	80	0.5	122353801	
88.9	25	63	80	0.9	122354801	12235480X
114.3	25	63	80	1.4	122355801	12235580X
139.7	25	63	80	2.0	122385801	12238580X
168.3	25	63	80	2.8	122383801	12238380X
219.1	30	40	80	6.0	122384801	12238480X
273.0	32	40	80	10.0	122369801	12236980X
323.9	32	40	80	16.7	122370801	12237080X

For larger sizes, see the section Alvenius AGS.

## Welding ring CG

We offer individual welding rings of all sizes to customise pipe sections.

These welding rings are of the same type as on the pipe ends and can be connected to the rest of the system.

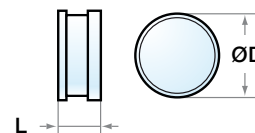

ØD [mm]	t [mm]	L [mm]	PN [bar] above ground	PN [bar] underground	Weight [kg]	Part no. Untreated
60,3	1,8	43	63	63	0,2	120983810
76,1	2.0	43	63	80	0.3	120280810
88,9	2.0	43	80	80	0.4	122985820
114,3	2.0	43	40	40	0.5	122851840
114,3	2.7	43	80	80	0.5	122851850
139,7	2.1	43	40	40	0.6	122852850
139,7	3.3	43	80	80	0.6	122852840
168,3	2.1	43	40	40	0.7	122855850
168,3	2.8	43	80	80	0.8	122855860
219,1	3.0	43	40	40	1.3	122865810
219,1	3.6	43	80	80	1.5	122865820
273,0	3.6	48	40	63	1.9	2117-00
273,0	4.4	48	63	80	2.2	2118-00
323,9	3.8	48	25	30	2.6	122844810
323,9	5.2	48	40	63	2.8	122844840
323,9	6.5	48	63	80	3.0	122844850

For larger sizes, see the section Alvenius AGS.

# Valves

To further complement the system, Alvenius offers a wide selection of different types of valves. The choice of valve is determined by multiple factors, such as valve type, application and pressure rating. Below are a number of images illustrating some of our valve range.

Examples of valves connected using a coupling: butterfly valves for lower pressure ratings, check valves, ball valves and knife gate valves.

Examples of valves connected using a flanged connector: butterfly valves for higher pressure ratings, gate valves and air release valves.

Type	Size range	Connection	Pressure rating [bar]
Butterfly valve	60–323 mm (2"–12")	CG coupling	21



Type	Size range	Connection	Pressure rating [bar]
Ball valve	60–168 mm (2"–6")	CG coupling	55



Type	Size range	Connection	Pressure rating [bar]
Butterfly valve	60–323 mm (2"–12")	Flanged connector	40



Type	Size range	Connection	Pressure rating [bar]
Knife gate valve	89–323 mm (3"–12")	CG coupling	10



## Plain end pipe

Black (untreated) pipes with plain ends are available for use in, for example, construction, welding, rolling or fitting/adjustment. The pipes have the same thickness and pressure rating as the quick coupling system. In addition to the sizes and pressure ratings in the table, custom sizes and pipe lengths can also be made to order.

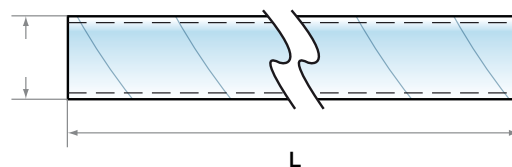

ØD [mm]	t [mm]	L [mm]	PN [bar] above ground	PN [bar] underground	Weight [kg]	Part no. Untreated
76,1	2.0	6000	40	40	21.9	101700330
76,1	2.0	9000	40	40	32.9	101701330
88,9	2.1	6000	80	80	27.0	101704330
88,9	2.1	9000	80	80	40.5	101705330
114,3	2.0	6000	25	25	33.2	101706330
114,3	2.0	9000	25	25	49.8	101707330
114,3	2.7	6000	40	40	44.6	101708330
114,3	2.7	9000	40	40	66.9	101709330
139,7	2.1	6000	25	25	42.8	101710330
139,7	2.1	9000	25	25	64.1	101711330
139,7	3.3	6000	80	80	66.5	101714330
139,7	3.3	9000	80	80	99.9	101715330
168,3	2.1	6000	40	40	51.6	101716330
168,3	2.1	9000	25	25	82.9	101717330
168,3	2.8	6000	40	40	68.6	101720330
168,3	2,8	12000	63	63	137.1	101721330
219,1	3.0	6000	25	25	95.9	101722330
219,1	3.0	12000	25	25	191.8	101723330
219,1	3.6	6000	63	63	114.8	101724330
219,1	3.6	12000	63	63	229.60	101725330
273,0	3.0	6000	25	25	120.20	101726330
273,0	3.0	12000	25	25	240.50	101727330
273,0	3.6	6000	40	40	114.00	101728330
273,0	3.6	12000	40	40	288.00	101729330
273,0	4.4	6000	40	40	175.50	101730330
273,0	4.4	12000	40	40	350.90	101731330
323,9	3.0	6000	40	40	142.40	101732330
323,9	3.0	12000	40	40	284.90	101733330
323,9	4.4	6000	40	40	208.00	101734330
323,9	4.4	12000	40	40	416.00	101735330
323,9	5.7	6000	63	63	268.40	101736330
323,9	5.7	12000	63	63	536.70	101737330

For larger sizes, see the section *Alvenius AGS*.

## Accessories, assembly grease

To simplify system installation and ensure maximum service life, Alvenius also offers assembly grease and Denso Tape, for example.

	Weight [gram]	Part no.
Tube	125	300029000
Can	907	300028000



## Accessories, Denso Tape

Width [mm]	L [m]	Part no.
100	10	800731000

## Accessories, repair kit, CorroFlo®

To simplify system installation and ensure maximum service life, Alvenius also offers assembly grease and Denso Tape, for example.

Colour	Designation	Part no.
Black	Complete kit	300050005
Black	Strips	300052005
White	Complete kit	300050006
White	Strips	300052006
Red	Complete kit	300050007
Red	Strips	300052007
Blue	Complete kit	300050009
Blue	Strips	300052009



Contents: Complete kit: 5 strips x 25 cm, 1 roller, 1 hot air gun  
Strips: 5 strips x 25 cm



## Alvenius® AGS 355–610 mm (14"–24")

**Alvenius AGS is a quick coupling system for larger sizes, 355 mm–610 mm (14"–24"). The system is normally available for pressures up to 25 bar.**

Alvenius pipes are spiral welded using unique pressure vessel quality steel material. This means that the pipes can be made thin-walled yet strong. Despite their large size, AGS couplings are comprised of two coupling halves, a rubber gasket and a nuts and bolts – just like the smaller size components. This makes for quick and simple installation even with large diameter pipe systems.

The AGS system can be ordered as hot-dip galvanized and with a CorroFlo® coating (size 24"/610 mm not available with CorroFlo®).

### Properties

- Sizes Ø355–610 mm
- Rigid or flexible couplings
- Wide selection of rubber gaskets depending on the application and the type of media to be transported in the pipe
- Self-sealing gasket. Also works in vacuums under certain conditions.
- Working temperature -35° to +110°
- Some play in the joints (flexible couplings)
- Unaffected by vibrations
- Absorbs axial movements in the pipe system thanks to axial play in the coupling



## Pipe AGS

Alvenius FlowMax® pipes are spiral welded using unique pressure vessel quality steel material. This means that the pipes can be made thin-walled yet strong while the spiral welding keeps the pipes straight.

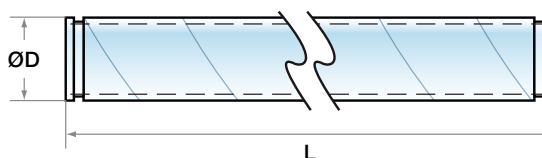

ØD [mm]	t [mm]	L [mm]	PN [bar] above ground	PN [bar] underground	Weight [kg]	Part no. Hot-dip galvanized	Part no. CorroFlo® •	Part no. RocShield® ••
355.6	5.6	600	40	40	29.0	3653-01	3653-0X	
355.6	5.6	1000	40	40	57.0	1819-01	1819-0X	
355.6	5.6	3000	40	40	157.9	1604-01	1604-0X	1604-2X
355.6	5.6	6000	40	40	304.9	1228-01	1228-0X	1228-2X
406.4	6.3	600	40	40	37.7	3657-01	3657-0X	
406.4	6.3	1000	40	40	62.6	3658-01	3658-0X	
406.4	6.3	3000	40	40	188.0	3659-01	3659-0X	3659-2X
406.4	6.3	6000	40	40	382.3	1229-01	1229-0X	1229-2X
457.0	6.3	600	40	40	42.5	3692-01	3692-0X	
457.0	6.3	1000	40	40	70.5	3693-01	3693-0X	
457.0	6.3	3000	40	40	210.6	3694-01	3694-0X	3694-2X
457.0	6.3	6000	40	40	429.6	1230-01	1230-0X	1230-2X
508.0	6.3	600	25	25	47.3	3698-01	3698-0X	
508.0	6.3	1000	25	25	78.5	3699-01	3699-0X	
508.0	6.3	3000	25	25	234.4	3700-01	3700-0X	3700-2X
508.0	6.3	6000	25	25	483.1	1231-01	1231-0X	1231-2X
610.0	6.3	600	25	25	57.0	3704-01	3704-0X	
610.0	6.3	1000	25	25	94.5	3705-01	3705-0X	
610.0	6.3	3000	25	25	282.1	3706-01	3706-0X	3706-2X
610.0	6.3	6000	25	25	571.0	2656-01	2656-0X	2656-2X

## Coupling Flexible, model AGS 77

Incl. rubber gasket (EPDM).

Sturdy flexible coupling for pressures up to PN25 depending on size. Flexible means that the coupling allows for some deflection and play, such as due to vibrations or temperature fluctuations. Contact Alvenius if you are uncertain as to which type of coupling to use.

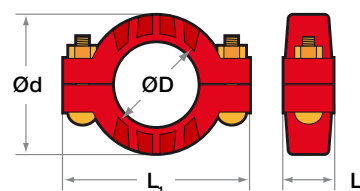

Product	ØD [mm]	Ød [mm]	L <sub>1</sub> [mm]	L <sub>2</sub> [mm]	Max. de- flexion °	PN [bar] above ground	PN [bar] under- ground	Weight [kg]	Part no. Painted	Part no. Hot-dip galvanized	Part no. CorroFlo® •
AGS 77	355.6	406	523	114	0.73	25	25	22.0	1115-10	1115-01	1115-0X
AGS 77	406.4	462	597	114	0.63	25	25	26.4	1113-10	1113-01	1113-0X
AGS 77	457.0	518	648	114	0.57	25	25	30.5	120829800	120829801	12082980X
AGS 77	508.0	573	689	114	0.50	25	25	37.3	1241-10	1241-01	1241-0X
AGS 77	610.0	683	794	114	0.42	25	25	48.5	3310-10	3310-01	3310-0X

- X=5 Black CorroFlo®, X=6 White CorroFlo®, X=7 Red CorroFlo®, X=9 Blue CorroFlo®
- X=5 Black RocShield®, X=6 White RocShield®, X=7 Red RocShield®, X=9 Blue RocShield®

## Coupling Rigid, model AGS 07

Incl. rubber gasket (EPDM).

Rigid coupling for pressures up to PN40 depending on size. Rigid means that the coupling is completely rigid and equivalent to a welded joint. Contact Alvenius if you are uncertain as to which type of coupling to use.

CorroFlo®-coated couplings can only be combined with welded pipe fittings due to the surface coating.

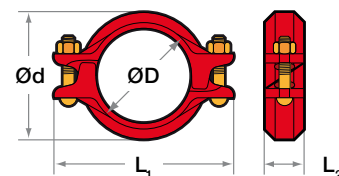

Product	ØD [mm]	Ød [mm]	L <sub>1</sub> [mm]	L <sub>2</sub> [mm]	Max. deflection °	PN [bar] above ground	PN [bar] underground	Weight [kg]	Part no. Painted	Part no. Hot-dip galvanized	Part no. CorroFlo® •
AGS 07	355.6	403	523	121	0.00	25	25	23.0	1134-10	1134-01	1134-0X
AGS 07	406.4	460	597	121	0.00	25	25	27.8	1112-10	1112-01	1112-0X
AGS 07	457.0	514	648	121	0.00	25	25	32.3	1118-10	1118-01	1118-0X
AGS 07	508.0	570	689	121	0.00	25	25	37.1	1240-10	1240-01	1240-0X
AGS 07	610.0	677	822	121	0.00	25	25	52.6	2909-10	2909-01	2909-0X

## Rubber gasket

EPDM rubber gaskets are included as standard with all couplings. If you need other rubber gaskets or additional spare rubber gaskets, a wide selection of gaskets are available depending on the application and media.

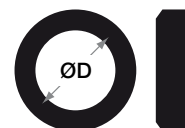

ØD [mm]	Weight [kg]	Part no.
355.6	1.0	4550-00
406.4	1.2	4551-00
457.0	1.3	4554-00
508.0	1.4	4552-00
610.0	1.8	4553-00

## Tee, AGS

The standard range includes a wide selection of straight tees, reducer tees and tees with threaded outlets.

Branch pipes, which are tees with a 45° branch, are available.

Tees are supplied with the same surface coating as the rest of the system.

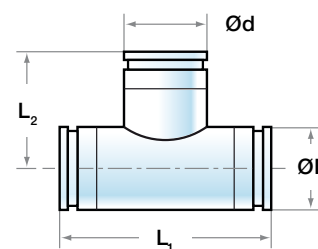

ØD [mm]	Ød [mm]	L <sub>1</sub> [mm]	L <sub>2</sub> [mm]	PN [bar] above ground	PN [bar] underground	Weight [kg]	Part no. Hot-dip galvanized	Part no. CorroFlo® •
355.6	219.1	558	248	25	25	47.5	2589-01	2589-0X
355.6	355.6	558	279	25	25	76.5	2597-01	2597-0X
406.4	168.3	610	264	25	25	57.2	3914-01	3914-0X
406.4	219.1	610	273	25	25	57.8	3913-01	3913-0X
406.4	355.6	610	305	25	25	61.1	3912-01	3912-0X
406.4	406.4	610	305	25	25	56.0	3911-01	3911-0X
457.0	168.3	686	289	25	25	72.6	3919-01	3919-0X
457.0	219.1	686	298	25	25	73.0	3918-01	3918-0X
457.0	355.6	686	330	25	25	76.0	3917-01	3917-0X
457.0	406.0	686	330	25	25	76.3	3916-01	3916-0X
457.0	457.0	686	343	25	25	127.0	3915-01	3915-0X
508.0	168.3	762	314	25	25	90.5	2591-01	2591-0X

Cont. on next page ►

# Tee, AGS, cont.

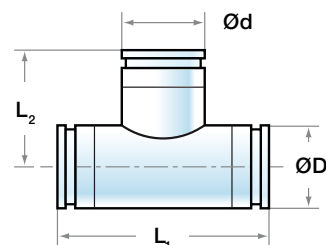

ØD [mm]	Ød [mm]	L <sub>1</sub> [mm]	L <sub>2</sub> [mm]	PN [bar] above ground	PN [bar] underground	Weight [kg]	Part no. Hot-dip galvanized	Part no. CorroFlo® •
508.0	219.1	762	324	25	25	90.0	3923-01	3923-0X
508.0	355.6	762	356	25	25	92.9	3922-01	3922-0X
508.0	406.4	762	356	25	25	93.0	3921-01	3921-0X
508.0	457.0	762	368	25	25	94.5	3920-01	3920-0X
508.0	508.0	762	381	25	25	160.0	2598-01	2598-0X
610.0	168.3	864	365	25	25	122.0	3930-01	3930-0X
610.0	219.1	864	375	25	25	123.0	3929-01	3929-0X
610.0	355.6	864	406	25	25	125.0	3928-01	3928-0X
610.0	406.4	864	406	25	25	125.0	3927-01	3927-0X
610.0	457.0	864	419	25	25	127.1	3926-01	3926-0X
610.0	508.0	864	432	25	25	128.0	3925-01	3925-0X
610.0	610.0	864	432	25	25	228.5	3924-01	3924-0X

# Elbow, AGS

Elbows are used when the deflection offered by the coupling is insufficient.  
Elbows are supplied with the same surface coating as the rest of the system.

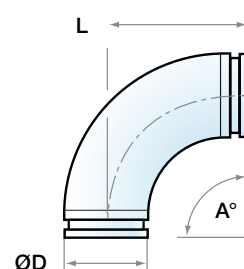

ØD [mm]	A°	L [mm]	PN [bar] above ground	PN [bar] underground	Weight [kg]	Part no. Hot-dip galvanized	Part no. CorroFlo® •
355.6	11.25	89.0	25	25	14.5	3725-01	3725-0X
355.6	22.50	127.0	25	25	20.9	3726-01	3726-0X
355.6	45.00	147.0	25	25	28.7	3727-01	3727-0X
355.6	90.00	355.6	25	25	68.4	3728-01	3728-0X
406.4	11.25	102.0	25	25	21.5	3729-01	3729-0X
406.4	22.50	127.0	25	25	23.6	3730-01	3730-0X
406.4	45.00	168.0	25	25	42.5	3731-01	3731-0X
406.4	90.00	406.4	25	25	83.6	3732-01	3732-0X
457.0	11.25	114.0	25	25	24.1	3936-01	3936-0X
457.0	22.50	140.0	25	25	29.5	3937-01	3937-0X
457.0	45.00	189.0	25	25	58.5	3788-01	3788-0X
457.0	90.00	457.2	25	25	123.5	3789-01	3789-0X
508.0	11.25	127.0	25	25	29.6	3733-01	3733-0X
508.0	22.50	152.0	25	25	36.0	3734-01	3734-0X
508.0	45.00	210.0	25	25	75.0	3735-01	3735-0X
508.0	90.00	508.0	25	25	141.5	3736-01	3736-0X
610.0	11.25	152.0	25	25	27.2	3939-01	3939-0X
610.0	22.50	178.0	25	25	63.5	3940-01	3940-0X
610.0	45.00	252.0	25	25	120.0	3790-01	3790-0X
610.0	90.00	609.6	25	25	253.9	3791-01	3791-0X

## Reducer/Taper, AGS

Reducers are used to connect pipes of different diameters.

The standard range includes a wide selection of reducers for connecting different diameters and reducers with threaded outlets.

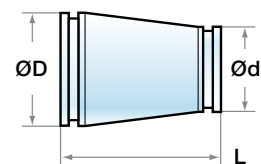

ØD [mm]	Ød [mm]	L [mm]	PN [bar] above ground	PN [bar] underground	Weight [kg]	Part no. Hot-dip galvanized	Part no. CorroFlo® •
355.6	168.3	152	25	25	31.0	2573-01	2573-0X
355.6	219.1	330	25	25	32.0	2574-01	2574-0X
355.6	273.0	330	25	25	33.0	2575-01	2575-0X
355.6	323.9	330	25	25	33.6	3772-01	3772-0X
406.4	219.1	356	25	25	39.9	3773-01	3773-0X
406.4	273.0	330	25	25	41.6	2576-01	2576-0X
406.4	323.9	356	25	25	47.6	122210801	12221080X
406.4	355.6	356	25	25	43.4	2577-01	2577-0X
457.0	273.0	381	25	25	50.8	3776-01	3776-0X
457.0	323.9	381	25	25	52.2	3775-01	3775-0X
457.0	355.6	381	25	25	53.5	3774-01	3774-0X
508.0	323.9	508	25	25	72.6	3779-01	3779-0X
508.0	355.6	508	25	25	74.4	3778-01	3778-0X
508.0	406.4	508	25	25	76.5	2578-01	2578-0X
508.0	457.0	508	25	25	78.0	3777-01	3777-0X
610.0	406.4	508	25	25	89.9	3782-01	3782-0X
610.0	457.0	508	25	25	90.7	3781-01	3781-0X
610.0	508.0	508	25	25	92.5	3780-01	3780-0X

## Flanged adapter AGS

Alvenius offers flanged connectors to easily connect the system to, for example, other pipe systems and flanged valves.

We can supply all types of DIN and ANSI flanges with different pressure ratings.

The entire flanged connector is supplied with the same surface coating as the rest of the system.

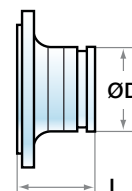

ØD [mm]	DN	DIN	L [mm]	PN [bar] above ground	PN [bar] underground	Weight [kg]	Part no. Hot-dip galvanized	Part no. CorroFlo® •
355.6	350	2632	203.0	10	10	30.4	2511-01	2511-0X
355.6	350	2633	203.0	16	16	37.8	3640-01	3640-0X
355.6	350	2634	203.0	25	25	51.5	3645-01	3645-0X
406.4	400	2632	203.0	10	10	40.8	2512-01	2512-0X
406.4	400	2633	203.0	16	16	48.4	3641-01	3641-0X
406.4	400	2634	203.0	25	25	70.1	3646-01	3646-0X
457.0	450	2632	203.0	10	10	47.7	3650-01	3650-0X
457.0	450	2633	203.0	16	16	60.2	3642-01	3642-0X
457.0	450	2634	203.0	25	25	84.5	3647-01	3647-0X
508.0	500	2632	203.0	10	10	57.0	2513-01	2513-0X
508.0	500	2633	203.0	16	16	79.7	3643-01	3643-0X
508.0	500	2634	203.0	25	25	102.7	3648-01	3648-0X
610.0	600	2632	203.0	10	10	65.6	3651-01	3651-0X
610.0	600	2633	203.0	16	16	120.5	3644-01	3644-0X
610.0	600	2634	203.0	25	25	146.2	3649-01	3649-0X

## End cap AGS

End caps are available in all sizes.

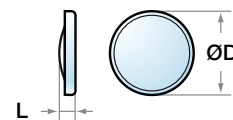

ØD [mm]	L [mm]	PN [bar] above ground	PN [bar] underground	Weight [kg]	Part no. Hot-dip galvanized	Part no. CorroFlo® •
355.6	165	25	25	15.1	3783-01	3783-0X
406.4	178	25	25	18.7	3784-01	3784-0X
457.0	203	25	25	24.8	3785-01	3785-0X
508.0	229	25	25	30.6	3786-01	3786-0X
610.0	267	25	25	43.5	3787-01	3787-0X

## Welding ring AGS

We offer individual welding rings of all sizes to customise pipe sections.

These welding rings are of the same type as on the pipe ends and can be connected to the rest of the system.

Contact Alvenius for more information.

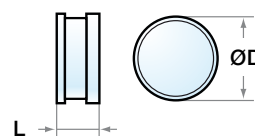

## Plain end pipe

Black (untreated) pipes with plain ends are available for use in, for example, construction, welding, rolling or fitting/adjustment. The pipes have the same thickness and pressure rating as the quick coupling system. In addition to the sizes and pressure ratings in the table, custom sizes and pipe lengths can also be made to order.

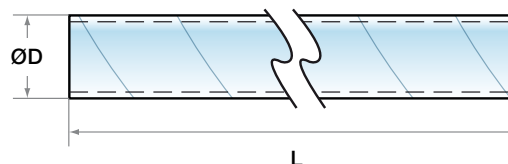

ØD [mm]	t [mm]	L [mm]	PN [bar] above ground	PN [bar] underground	Weight [kg]	Part no. Untreated
355	5.6	6000	25	25	290	1243-00
355	5.6	12000	25	25	579	Contact Alvenius
406	6.3	6000	25	25	373	101740330
406	6.3	12000	25	25	745	101741330
457	6.3	6000	25	25	420	3601-00
457	6.3	12000	25	25	840	Contact Alvenius
508	6.3	6000	25	25	468	101744330
508	6.3	12000	25	25	935	101745330
610	6.3	6000	25	25	563	1096-00
610	6.3	12000	25	25	1125	2848-00





## Alvenius® K10 48–318 mm (1½"–12")

**Alvenius K10 is a quick coupling system with a "shoulder" at each end of the pipe. The system is available in standard metric sizes for pressures up to 40 bar, depending on size. The K10 system is easier to install compared to the CG/RG systems. It offers greater flexibility with deflection up to 4°.**

Alvenius pipes are spiral welded using unique pressure vessel quality steel material. This means that the pipes can be made thin-walled yet strong. The low weight/quick coupling combination makes for a system that is extremely easy to manage and install.

Pipes and pipe fittings are supplied hot-dip galvanized as standard. Other surface coatings to order.

K70 is an articulated coupling for even faster and more flexible installation – just one single bolt needs tightening.

### Properties

- Sizes Ø48–318 mm
- Self-sealing gasket. Also works in vacuums under certain conditions.
- EPDM rubber gasket as standard, which is also resistant to chemicals.
- Working temperature -35° to +110°
- Optional nitrile or silicone gasket for long-term contact with petroleum products.
- Deflection up to 4°
- Unaffected by vibrations
- Absorbs axial movements in the pipe system thanks to axial play in the coupling

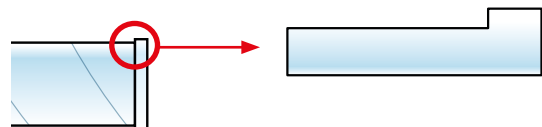

# Pipe K10

Alvenius FlowMax® pipes are spiral welded using unique pressure vessel quality steel material. This means that the pipes can be made thin-walled yet strong while the spiral welding keeps the pipes straight.

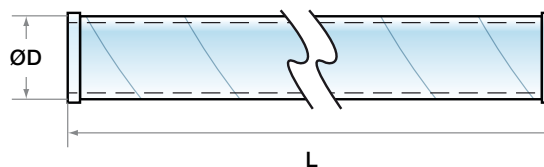

ØD [mm]	t [mm]	L [mm]	PN [bar]	Weight [kg]	Part no. Hot-dip galvanized
48.3	1.4	200	63	0.4	100032101
48.3	1.4	500	63	0.9	100034101
48.3	1.4	1000	63	1.8	100035101
48.3	1.4	2000	63	3.7	100036101
48.3	1.4	3000	63	5.4	100037101
48.3	1.4	5800	63	10.6	100041101
60.3	1.8	200	80	0.6	101122101
60.3	1.8	500	80	1.4	101124101
60.3	1.8	1000	80	2.8	101125101
60.3	1.8	2000	80	5.8	101126101
60.3	1.8	3000	80	8.6	101127101
60.3	1.8	5800	80	16.6	101131101
60.3	1.8	6000	80	17.0	1541-01
76.1	2.0	200	63	1.0	100071101
76.1	2.0	500	63	2.0	100074101
76.1	2.0	1000	63	3.9	100075101
76.1	2.0	2000	63	8.0	100076101
76.1	2.0	3000	63	12.0	100077101
76.1	2.0	5800	63	22.9	100081101
76.1	2.0	6000	63	23.7	100080101
101.6	2.0	200	40	1.3	100120101
101.6	2.0	500	40	2.7	100104101
101.6	2.0	1000	40	5.1	100105101
101.6	2.0	2000	40	10.9	100106101
101.6	2.0	3000	40	16.3	100107101
101.6	1.25	5800	25	20.4	2122-01
101.6	2.0	5800	40	31.0	100111101
101.6	2.0	6000	40	32.1	1542-01
152.4	2.1	200	40	2.2	100142111
152.4	2.1	500	40	4.3	100144111
152.4	2.1	1000	40	8.1	100145111
152.4	2.1	2000	40	17.5	100146111
152.4	2.1	3000	40	25.8	100147111
152.4	1.25	5800	16	30.6	2119-01
152.4	2.0	5800	25	46.9	101240101
152.4	2.0	6000	25	48.5	1540-01
152.4	2.1	5800	40	48.8	100160101
152.4	2.1	6000	40	50.5	2905-01
203.2	3.0	200	40	5.6	100188101
203.2	3.0	500	40	10.8	100193101
203.2	3.0	1000	40	17.5	100194101

Cont. on next page ►

## Pipe K10, cont.

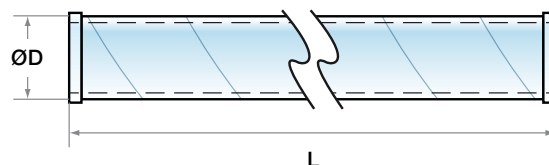

ØD [mm]	t [mm]	L [mm]	PN [bar]	Weight [kg]	Part no. Hot-dip galvanized
203.2	3.0	2000	40	34.4	100195101
203.2	3.0	3000	40	50.0	100196101
203.2	3.0	5800	40	92.4	100192101
203.2	3.0	6000	40	93.2	100191101
254.0	3.0	500	25	12.0	100213101
254.0	3.0	1000	25	21.6	100214101
254.0	3.0	2000	25	37.1	1828-01
254.0	3.0	3000	25	62.1	100216101
254.0	3.0	5800	25	119.0	100212101
318.0	3.0	500	25	19.1	2001-01
318.0	3.0	1000	25	31.3	2002-01
318.0	3.0	2000	25	55.7	2003-01
318.0	3.0	3000	25	80.2	2004-01
318.0	3.0	5800	25	148.6	2000-01

For larger sizes, see the section Alvenius AGS.

## Coupling K10

Incl. rubber gasket (EPDM).

Flexible coupling for pressures up to 40 bar depending on size. Flexible means that the coupling allows for some deflection and play, such as due to vibrations or temperature fluctuations. Contact Alvenius if you are uncertain as to which type of coupling to use.

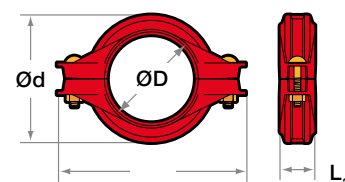

ØD [mm]	Ød [mm]	L <sub>1</sub> [mm]	L <sub>2</sub> [mm]	Max. deflection	PN [bar]	Weight [kg]	Part no. Painted
48.3	77.0	124	37	5.0	25	0.6	120258109
60.3	86.7	133	39	4.0	25	0.7	120267109
76.1	109.0	168	40	4.0	25	1.1	120276109
101.6	139.0	208	46	2.5	25	1.7	120290109
152.4	201.5	280	55	2.0	40	3.1	120311109
203.2	265.0	350	83	2.0	25	6.6	120330109
254.0	308.0	424	87	1.4	16	10.9	120345109
318.0	393.0	490	89	1.2	16	17.7	120360109

For larger sizes, see the section Alvenius AGS.

## Coupling K70

Incl. rubber gasket (EPDM).

The K70 is similar to the K10 coupling, but is articulated on one side and as such has only one bolt, used for extra quick connection. Moreover, the bolt is fitted, which means few loose fittings.

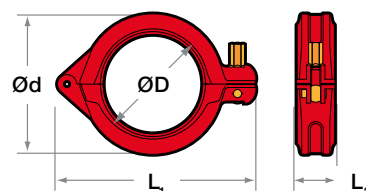

ØD [mm]	Ød [mm]	L <sub>1</sub> [mm]	L <sub>2</sub> [mm]	Max. deflection	PN [bar]	Weight [kg]	Part no. Painted
48.3	67.4	130	37	6.5	25	0.67	120900709
60.3	79.0	142	40	5.0	25	0.77	120901709
76.1	100.0	162	40	5.0	25	1.00	120902709
101.6	129.0	210	46	2.5	25	1.79	120903709
152.4	201.5	293	55	2.5	25	3.78	120904709

For larger sizes, see the section Alvenius AGS.

## Rubber gasket

EPDM rubber gaskets are included as standard with all couplings. If you need other rubber gaskets or additional spare rubber gaskets, a wide selection of gaskets are available depending on the application and media.

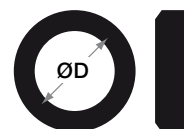

ØD [mm]	Weight [kg]	Part no.
48.3	0.1	120264101
60.3	0.1	120273101
76.1	0.1	120282101
88.9	0.1	120287101
101.6	0.1	120296101
133.0	0.1	120308101
152.4	0.2	120315101
203.2	0.3	120334101
254.0	0.4	120349101
318.0	0.8	120363101

For larger sizes, see the section Alvenius AGS.

## Tee K10

The standard range includes a wide selection of straight tees, reducer tees and tees with threaded outlets.

Branch pipes, which are tees with a 45° branch, are available.

Tees are supplied with the same surface coating as the rest of the system.

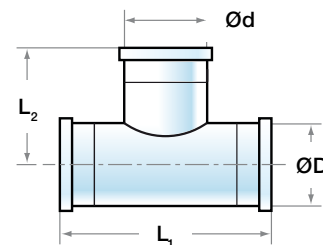

ØD [mm]	ØD [mm]	L <sub>1</sub> [mm]	L <sub>2</sub> [mm]	PN [bar]	Weight [kg]	Part no. Hot-dip galvanized
48.3	48.3	148	99	63	0.7	111696101
60.3	48.3	160	105	63	0.7	111697101
60.3	60.3	160	105	63	0.7	111698101
76.1	48.3	176	113	40	1.0	111699101
76.1	60.3	176	113	25	1.0	111700101
76.1	76.1	176	176	40	1.2	111701101
101.6	48.3	202	125	25	1.4	111705101
101.6	60.3	202	125	40	1.5	111706101
101.6	76.1	202	151	16	1.8	111707101
101.6	101.6	202	151	40	4.2	2050-01
152.4	60.3	252	125	16	3.5	111718101
152.4	76.1	252	151	25	3.2	111712101
152.4	101.6	249	174	40	7.4	1495-01
152.4	152.4	252	156	10	4.0	2389-01
203.2	101.6	509	202	16	10.0	111725101
203.2	152.4	509	202	10	11.1	111727101
203.2	203.2	509	255	10	14.0	111728101
254.0	203.2	560	280	10	20.5	111732101
254.0	254.0	560	280	10	19.5	111733101
318.0	203.0	628	279	25	40.0	111741101

For larger sizes, see the section Alvenius AGS.

## Branch 45° K10

The standard range includes a wide selection of straight tees, reducer tees and tees with threaded outlets.

Branch pipes, which are tees with a 45° branch, are available.

Tees are supplied with the same surface coating as the rest of the system.

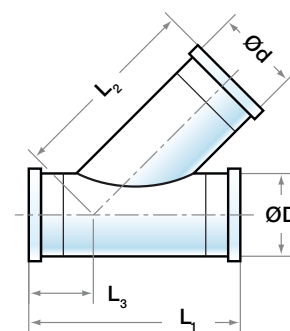

ØD [mm]	Ød [mm]	L <sub>1</sub> [mm]	L <sub>2</sub> [mm]	L <sub>3</sub> [mm]	PN [bar]	Weight [kg]	Part no. Hot-dip galvanized
48.3	48.3	225	194	88	100	2.8	110173101
76.1	76.1	280	250	102	16	2.1	110178101
101.6	101.6	325	316	112	10	3.2	110184101
152.4	152.4	400	380	125	6	6.9	110189101
203.2	203.2	500	500	140	6	15.3	110190101
254.0	254.0	600	600	150	5	24.4	110191101



## Tee with threaded outlet K10

The standard range includes a wide selection of straight tees, reducer tees and tees with threaded outlets.

Branch pipes, which are tees with a 45° branch, are available.

Tees are supplied with the same surface coating as the rest of the system.

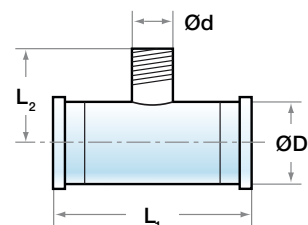

ØD [mm]	Ød [mm]	L <sub>1</sub> [mm]	L <sub>2</sub> [mm]	PN [bar]	Weight [kg]	Part no. Hot-dip galvanized
48.3	R1"	148	80	100	0.5	111743101
48.3	R2"	152	97	63	1.5	111744101
60.3	R1"	160	87	63	0.7	111745101
60.3	R2"	160	70	63	1.0	111746101
76.1	R1"	176	97	63	1.0	111748101
76.1	R2"	176	88	63	1.1	111749101
101.6	R1"	202	108	40	1.4	111752101
101.6	R2"	202	108	40	1.6	111909101
152.4	R1"	252	135	40	3.1	111756101
152.4	R2"	252	126	40	6.2	2390-01
152.4	R4"	252	206	25	4.1	111757101

## Elbow K10

Elbows are used when the deflection offered by the coupling is insufficient.

Elbows are supplied with the same surface coating as the rest of the system.

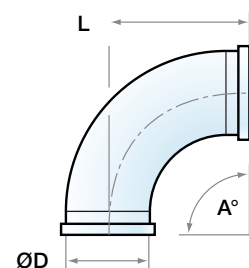

ØD [mm]	A°	L [mm]	PN [bar]	Weight [kg]	Part no. Hot-dip galvanized
48.3	7.5	52	25	0.3	110445101
48.3	15.0	53	25	0.2	110446101
48.3	30.0	60	40	0.4	110447101
48.3	45.0	69	16	0.4	110448101
48.3	90.0	102	16	0.6	110450101
60.3	7.5	52	25	0.3	110466101
60.3	15.0	54	16	0.4	110467101
60.3	30.0	65	63	0.6	110468101
60.3	45.0	76	63	0.6	110469101
60.3	90.0	121	63	0.8	110471101
76.1	7.5	51	16	0.5	110487101
76.1	15.0	51	16	0.6	110488101
76.1	30.0	70	63	0.9	110489101
76.1	45.0	84	63	0.9	110490101
76.1	90.0	140	63	1.5	110492101
101.6	15.0	51	40	1.8	110530111
101.6	30.0	81	40	2.6	110531111
101.6	45.0	100	40	2.6	110532111
101.6	90.0	178	40	4.7	110524111

Cont. on next page ►

## Elbow K10, cont.

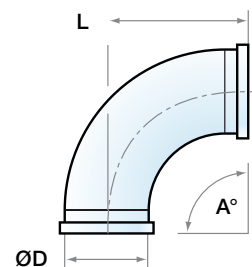

ØD [mm]	A°	L [mm]	PN [bar]	Weight [kg]	Part no. Hot-dip galvanized
152.4	7.5	59	40	3.4	112401101
152.4	15.0	74	40	4.1	112402101
152.4	30.0	103	40	5.5	112403101
152.4	45.0	135	40	6.9	112404101
152.4	90.0	261	40	10.6	112405101
203.2	7.5	64	40	5.0	111220101
203.2	15.0	83	40	5.9	111221101
203.2	30.0	122	40	7.6	111222101
203.2	45.0	164	40	9.6	111223101
203.2	90.0	333	40	15.8	111225101
254.0	7.5	75	40	8.5	111075101
254.0	15.0	100	40	10.8	111076101
254.0	30.0	152	40	15.8	111077101
254.0	45.0	208	40	19.0	111078101
254.0	90.0	431	40	30.7	111080101
318.0	7.5	90	25	12.2	110679101
318.0	15.0	120	25	15.5	110678101
318.0	30.0	182	25	22.0	110680101
318.0	45.0	249	25	29.3	110676101
318.0	90.0	517	25	49.0	110681101

For larger sizes, see the section Alvenius AGS.

## Reducer/Taper K10

Reducers are used to connect pipes of different diameters.

The standard range includes a wide selection of reducers for connecting different diameters and reducers with threaded outlets.

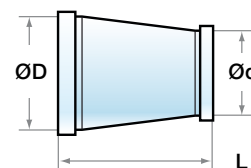

ØD [mm]	Ød [mm]	L [mm]	PN [bar]	Weight [kg]	Part no. Hot-dip galvanized
60.3	48.3	88	80	0.3	111850101
76.1	48.3	88	63	0.4	111851101
76.1	60.3	85.4	63	0.4	111852101
101.6	48.3	128	40	1.4	2052-01
101.6	60.3	85	40	0.5	111862101
101.6	76.1	85	40	0.6	111863101
152.4	48.3	165	40	1.6	111866101
152.4	76.1	184	40	1.9	111867101
152.4	101.6	185	40	3.6	2053-01
203.2	152.4	197	40	6.0	111875101

Cont. on next page ►

## Reducer/Taper K10, cont.

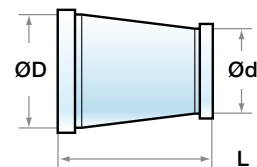

ØD [mm]	Ød [mm]	L [mm]	PN [bar]	Weight [kg]	Part no. Hot-dip galvanized
254.0	152.4	221	40	9.0	111880101
254.0	203.2	278	40	12.0	111879101
318.0	203.2	313	25	16.0	111204101
318.0	254.0	313	25	18.5	800893101

For larger sizes, see the section Alvenius AGS.

## Adapter K10 with thread

Adapter with thread used to connect pipes to, for example, threaded valves or a threaded pipe system.

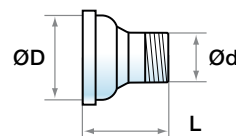

ØD [mm]	Ød [mm]	L [mm]	PN [bar]	Weight [kg]	Part no. Hot-dip galvanized
48.3	R1"	105	40	0.6	2785-01
48.3	R1½"	85	40	0.3	110289111
48.3	R2"	105	25	0.5	110215101
60.3	R1"	132	25	0.5	110216101
60.3	R2"	105	25	0.5	110217101
60.3	R2½"	134	25	0.9	110218101
76.1	R1"	197	63	0.8	110219101
76.1	R2"	104	25	0.6	110221101
76.1	R2½"	125	25	0.9	1489-01
101.6	R2"	142	25	1.1	110227101
101.6	R3"	155	25	1.7	110229101
101.6	R4"	193	25	2.3	110230101
152.4	R2"	154	40	2.0	3027-01
152.4	R6"	195	25	4.4	110237101

## Adapter K10 – CG

Used to connect the K10 and CG systems.

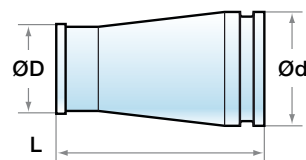

ØD [mm]	Ød [mm]	L [mm]	PN [bar]	Weight [kg]	Part no. Hot-dip galvanized	Part no. CorroFlo® •
60.3	60.3	88	40	0.5	111 896 801	
76.1	76.1	88	40	0.6	4439-01	
101.6	114.3	88	40	1.0	112 046 801	11204680X
152.4	139.7	88	40	1.5	111 873 801	
152.4	168.3	88	40	3.0	111 874 801	11187480X
203.2	219.1	93	40	3.6	111 879 801	11187980X

## Flanged adapter K10

Alvenius offers flanged connectors to easily connect the system to, for example, other pipe systems and flanged valves. We can supply all types of DIN and ANSI flanges with different pressure ratings.

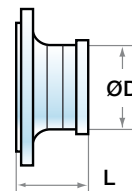

ØD [mm]	DN	DIN	L [mm]	PN [bar]	Weight [kg]	Part no. Hot-dip galvanized
48.3	40	2633	89	16	2.2	111768101
60.3	60	2633	89	16	2.6	111771101
76.1	65	2633	89	16	3.3	111774101
101.6	100	2633	95	16	4.9	111780101
152.4	150	2633	99	16	8.6	111763101
152.4	150	2635	118	40	12.7	111763111
203.2	200	2632	111	10	13.1	111789101
203.2	200	2633	112	16	12.8	811790101
254.0	250	2632	118	10	18.2	111795101
254.0	250	2633	120	16	19.1	111796101
318.0	300	2632	128	10	24.0	111799101
318.0	300	2633	138	16	26.3	4338-01

For larger sizes, see the section Alvenius AGS.

## Hose connection K10

Used to connect the K10 system to a hose.

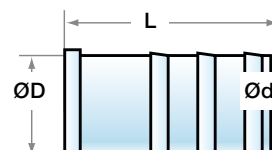

ØD [mm]	Ød [mm]	L [mm]	PN [bar]	Weight [kg]	Part no. Hot-dip galvanized
48.3	1"	185.0	25	0.4	111679101
48.3	1½"	142.5	25	0.5	111680101
48.3	2"	175.0	100	0.9	111279101
60.3	2"	211.0	25	1.2	111683101
76.1	1"	221.0	25	0.9	111684111
76.1	2"	211.0	25	1.1	111684101
76.1	3"	215.0	100	1.6	111281101
101.6	2"	248.0	25	1.3	111685101
101.6	3"	252.0	25	2.4	111686101
101.6	4"	230.5	100	2.7	111283101
152.4	6"	293.5	100	5.7	111285101
203.2	8"	350.0	100	7.0	111690101

## Butterfly valve K10

Alvenius offers valves suited to the system.

We offer butterfly valves for direct connection with a quick coupling.

Through our partners, we can offer all types of specialised valves.

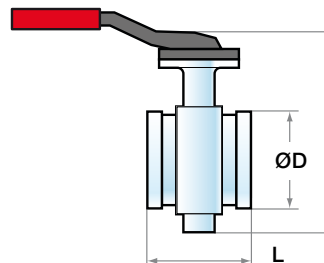

ØD [mm]	L [mm]	Ød [mm]	PN [bar]	Weight [kg]	Part no. Painted cast iron
60.3	86	204	16	2.4	2943-10
76.1	98	221	16	3.0	2944-10
101.6	116	275	16	3.9	2945-10
152.4	148	375	16	7.9	2946-10

## Slide valve K10

Alvenius offers valves suited to the system.

We offer slide valves for direct connection with a quick coupling.

Through our partners, we can offer all types of specialised valves.

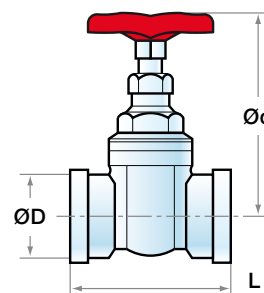

ØD [mm]	L [mm]	Ød [mm]	PN [bar]	Weight [kg]	Part no. Bronze	Part no. Painted cast iron
48.3	110	138	16	1.4	130 001 000	
48.3	110	270	16	6.5		130001108
60.3	120	165	16	2.2	130 002 000	
60.3	120	283	16	7.8		130002108
76.1	125	220	16	5.9	130 003 000	
76.1	125	310	16	9.6		130003108
101.6	142	397	16	8.5	130 004 000	
101.6	142	350	16	14.0		130004108
152.4	200	382	16	19.5	130 005 000	
152.4	200	485	16	31.5		130005108
203.2	270	520	16	62.0		130006108



## End cap K10

End caps are available in all sizes.

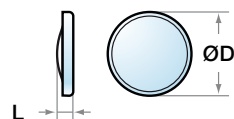

ØD [mm]	L [mm]	PN [bar]	Weight [kg]	Part no. Hot-dip galvanized
48.3	68	40	0.0	110349101
60.3	72	40	0.1	110351101
76.1	77	40	0.2	110353101
101.6	83	40	0.8	110357101
152.4	98	40	0.9	110361101
203.2	120	25	4.4	110364101
254.0	136	40	8.1	110366101
318.0	160	25	13.2	110367101

For larger sizes, see the section Alvenius AGS.

## Welding ring

We offer individual welding rings of all sizes to customise pipe sections on-site.

These welding rings are of the same type as on the pipe ends and can be connected to the rest of the system.

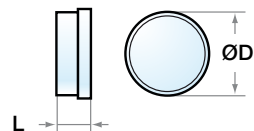

ØD [mm]	t [mm]	L [mm]	PN [bar] above ground	Weight [kg]	Part no. Untreated
48	1.8	43	40	0.1	121898100
60	2.0	43	40	0.2	121899100
76	2.0	43	40	0.2	121910100
102	2.0	43	40	0.3	121902100
152	2.5	43	40	0.7	121904100
203	3.0	43	16	1.7	120334100
254	3.0	48	16	2.7	120347100
318	4.0	58	16	4.6	120362100

For larger sizes, see the section Alvenius AGS.





Your VAT no. 1234

Delivery address  
Customer A  
Street A  
SE-631 07 Eskilstuna  
Sweden

Terms of delivery  
FCA Eskilstuna Incoterms 2010  
Delivery method  
Truck  
Del. period = shipped our warehouse

Pos	Part no.	Name
1	100885825	Rohr CG 219x3,0 L=6000 S/RC

## Order Confirmation

Order no. 839027  
Customer code 9998  
Printout date 2018-08-17  
Your reference Anna Andersson

Page 1 / 1



Your VAT no. 1234

Delivery address  
Customer A  
Street A  
SE-631 07 Eskilstuna  
Sweden

Terms of delivery  
FCA Eskilstuna Incoterms 2010  
Delivery method  
Truck  
Del. period = shipped our warehouse

Pos	Part no.	Name	Del. period
1	100885825	Rohr CG 219x3,0 L=6000 S/RC	

## Order Confirmation

Order no. 839027  
Customer code 9998  
Order date 2018-08-17  
Our reference Anna Andersson  
Printout date 2018-08-17  
Your reference Lars Larsson

Page 1 / 1

Mailing address  
Customer A  
PO Box. X  
SE-631 07 Eskilstuna  
Sweden

Terms of payment  
30 days net  
After due date, a late payment fee will be charged at 8,00%  
Goods label

# Type designation

## Pipe

100420829	Pipe	CG	114	x	2.0	L=5800	B	/	RC
Part number	Part	Profile	Ø	Thickness	Length	Colour	Surface coating		
		CG = cut groove				S = black	FZV = hot-dip galvanized		
		RG = rolled groove				B = blue	TP = CorroFlo®		
		AGS = rolled groove				R = red	RC = RocShield®		
		K10 = shouldered				V = white	S = Untreated		

## Coupling

120935805	Coupling	VIC	114	x	St 75	S	/	TP
Part number	Part	Profile	Ø	Product name	Colour	Surface coating		
		K10 = shouldered			S = black	FZV = hot-dip galvanized		
		VIC = Victaulic			B = blue	TP = CorroFlo®		
					R = red	RC = RocShield®		
					V = white	S = Untreated		

## Tee

111698101	Tee	K10	60	/	60	FZV
Part number	Part	Profile	Ø pipe	Ø pipe (protrusion)	Surface coating	
		CG = cut groove			FZV = hot-dip galvanized	
		RG = rolled groove			TP = CorroFlo®	
		AGS = rolled groove			RC = RocShield®	
		K10 = shouldered			S = Untreated	

## Elbow

1078-01	Elbow	CG	273	90°	Gj	RC
Part number	Part	Profile CG = cut groove RG = rolled groove AGS = rolled groove K10 = shouldered	Ø	Elbow angle	Cast	Surface coating FZV = hot-dip galvanized TP = CorroFlo® RC = RocShield® S = Untreated

## Reducer

111863101	Reducer	K10	102 / 76	L=5800	RC	
Part number	Part	Profile	Ø	Ø	Length	Surface coating
		CG = cut groove				FZV = hot-dip galvanized
		RG = rolled groove				TP = CorroFlo®
		AGS = rolled groove				RC = RocShield®
		K10 = shouldered				S = Untreated

## Adapter

110217801	Adapter	CG	60	R2"	FZV
Part number	Part	Profile CG = cut groove RG = rolled groove AGS = rolled groove K10 = shouldered	Ø	Thread size	Surface coating FZV = hot-dip galvanized TP = CorroFlo® RC = RocShield® S = Untreated

## Hydrant outlet

122717807	Hydrant outlet	CG	114 / 2"	L=5800	B /	RC	
Part number	Part	Profile	Ø	Thread size	Length	Colour	Surface coating
		CG = cut groove				S = black	FZV = hot-dip galvanized
		RG = rolled groove				B = blue	TP = CorroFlo®
		AGS = rolled groove				R = red	RC = RocShield®
		K10 = shouldered				V = white	S = Untreated

## Flanged adapter

111776805	Adapter	CG	-	FL	x 89	PN63	S	/	TP
Part number	Part	Profile		Flange	Ø	Pressure	Colour		Surface coating
		CG = cut groove					S = black		FZV = hot-dip galvanized
		RG = rolled groove					B = blue		TP = CorroFlo®
		AGS = rolled groove					R = red		RC = RocShield®
		K10 = shouldered					V = white		S = Untreated

## End cap

122384801	End cap	CG	219	Gj	FZV
Part number	Part	Profile CG = cut groove RG = rolled groove AGS = rolled groove K10 = shouldered	Ø	Cast	Surface coating FZV = hot-dip galvanized TP = CorroFlo® RC = RocShield® S = Untreated

**More information**

This product catalogue covers the entire standard Alvenius range: pipes, couplings, valves, elbows, tees, adapters, threaded outlets and more.

Further information about the company and our products can be found at: [www.alvenius.com](http://www.alvenius.com)

You can download drawings in formats such as CAD here: [www.alvenius.solidcomponents.com](http://www.alvenius.solidcomponents.com)

All information in this publication is given in good faith, and believed to be correct at the time of going to press. However, no responsibility can be accepted for any errors, omissions or incorrect assumptions.

Alvenius reserves the right to make alternations without prior notice. Due to continuous product development, changes in technical specifications may change. Installations must comply with the installations instructions.





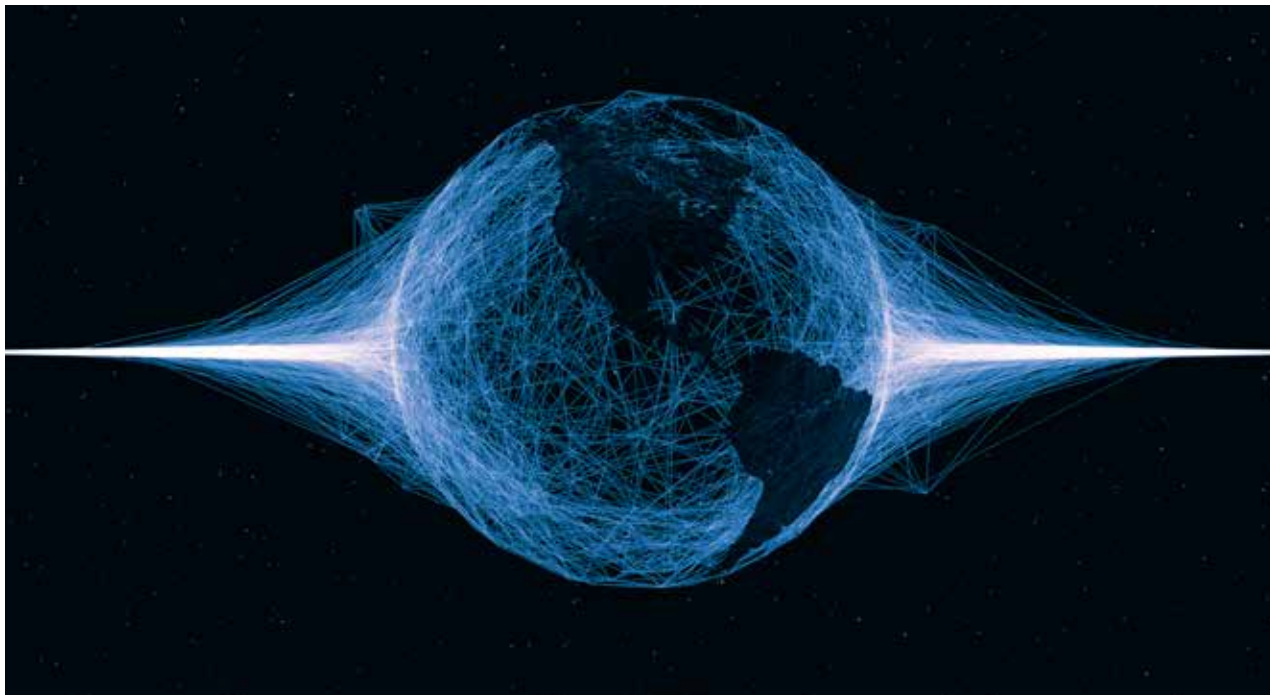

Alvenius was founded in 1951 and ever since we have focused on supplying the global market with high-quality quick coupling steel pipe systems.

Today, Alvenius focuses its expertise on the segments tunnels, mines, industry, fire protection and extinguishing, water and wastewater systems and artificial snow making.

We have a presence in Asia, Africa, the Middle East, North and South America, Europe and, of course, our domestic market Sweden.

Our international approach offers many advantages.

Above all else, it means that we understand the conditions and demands of your particular market – wherever that may be.



Member of Boxholm Group



**AB Alvenius Industrier** • P.O. Box 550 • SE-631 07 Eskilstuna • Sweden • Phone: +46 16 16 65 00 • Fax: +46 16 12 26 34  
Email: [info@alvenius.se](mailto:info@alvenius.se) • [alvenius.com](http://alvenius.com)

